

030-1300 D-Paddle Handle



This compartment paddle handle is designed for utility and service bodies, emergency vehicles and baggage doors for recreational vehicles. It features a multipoint bellcrank and is available in black or buffed copper-nickel-chrome finishes.

DESIGNED FOR:

- Service and utility truck body doors
- Compartment doors on recreational vehicles
- Most storage, compartment and access doors
- Emergency vehicle compartment doors



TriMark Corporation

500 Bailey Avenue
P.O. Box 350

New Hampton, Iowa 50659
United States

Tel: 641-394-3188

Fax: 641-394-2392

1-800-447-0343

www.trimarkcorp.com

10002707 QM08 ISO 9001: 2008
10002707 TS09 ISO/TS 16949: 2009



TriMark Corporation

TriMark Europe

Cedar Court
Walker Road

Bardon Hill
Coalville LE67 1TU

United Kingdom

Tel: +44(0)1530 512460

Fax: +44(0)1530 512461

www.trimarkeu.com

427961 QM08 ISO 9001 : 2008
427961 UM ISO 14001 : 2004



TriMark Europe Ltd.



030-1300 D-Paddle Handle

AVAILABLE:

- In locking or non-locking configurations
- With single rotor latch module (050-0206) that can be orientated at 90° intervals with the paddle depending on application
- With gasket for flange of housing to provide resistance to water and dirt infiltration
- Multiple pivot plate for doors that require a remote latching mechanism

USE WITH:

- Please refer to our website for related products that are compatible for use with this product

MATERIAL:

- Housing and paddle: die cast zinc alloy
- Internal latch components: case hardened, smooth edge stamped steel
- Springs: stainless steel, non-corrosive
- Other components: zinc plate mild steel

FINISH:

- Housing and paddle: black powder coated or buffed copper-nickel-chrome plated
- Stampings: zinc plate clear chromate conversion coat

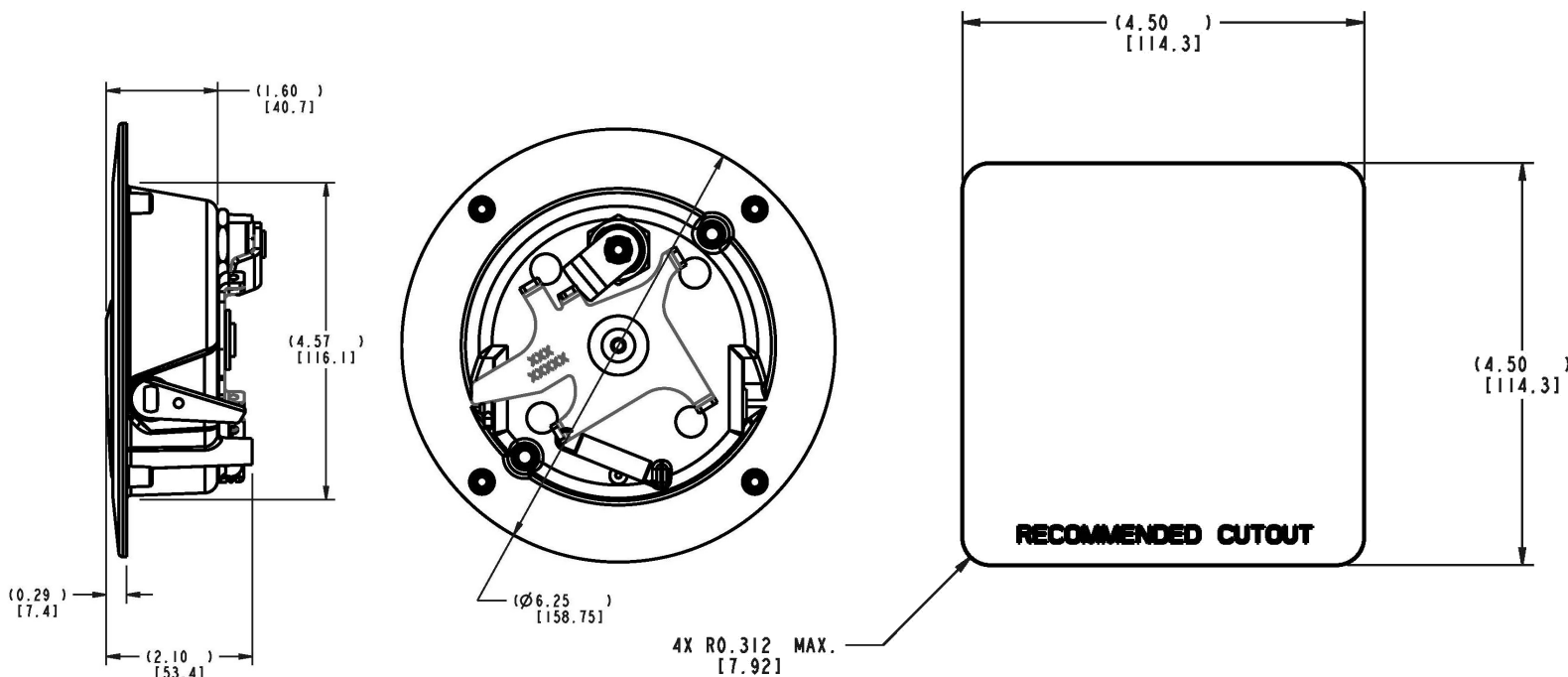

INSTALLATION:

- Easy drop-in installation
- Integrated rotary: mounts with (2) 1/4-20 UNC threaded cutting screws (not included)
- 2-point: mounts with (4) #10-24 UNC screws (not included)
- Retrofits with most folding D-ring handles presently used

Individual part dimensions are for reference only. Refer to individual part drawings for complete dimensions, specifications, and installation procedures. Engineering assistance and application drawings are available.

CAUTION: Product does not meet the locking requirements for FMVSS 206.

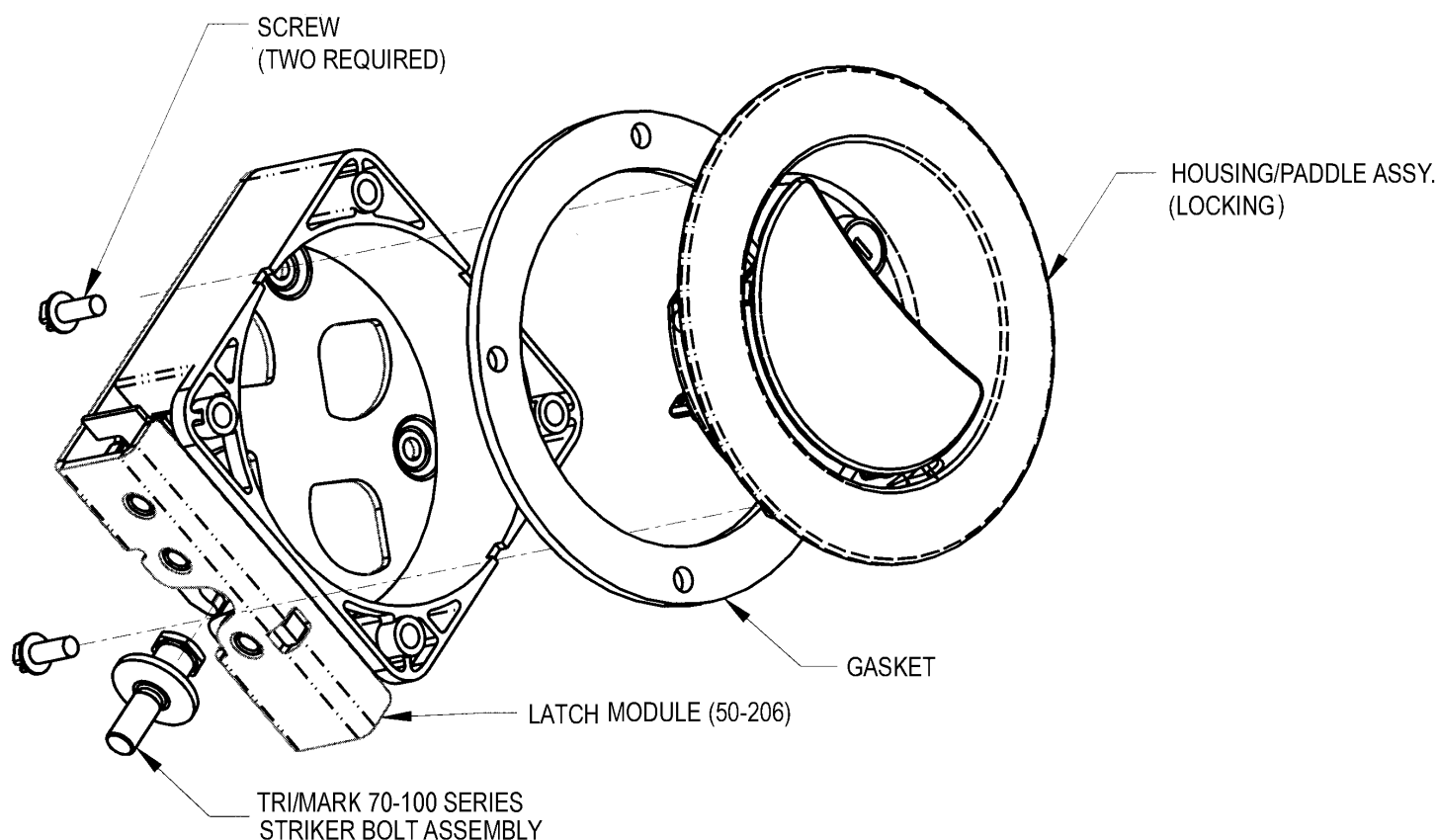

D-PADDLE WITH ROTARY LATCH MODULE

For more information visit
www.trimarkcorp.com